

1" VersaLux Retrofit Mounting Kit

For use with VLN1 and SDN1

Installation Instructions

Usage

Lighting Module Mounting Kit has been developed to help overcome difficulties in attaching the fixture's Lighting Module if the fixture Housing was not properly installed (ex., fixture is: twisted, bowed or has other distortions due to uneven ceiling surfaces).

When installed, it will retract the Lighting Module into the Housing as best as possible and ensure it will not disengage accidentally.

The Lighting Module may not be flush to the Housing due the distortions in the Housing which cannot be resolved without properly reinstalling the Housing.

The retrofit kit is for use in VLN1 and SDN1 fixtures only – Lighting Module issues found in the 1" Pendant Series fixtures can easily be resolved by leveling the Housing using the adjustable aircraft cables and verifying the Retention Clip brackets are properly distributed along the length of the fixture.

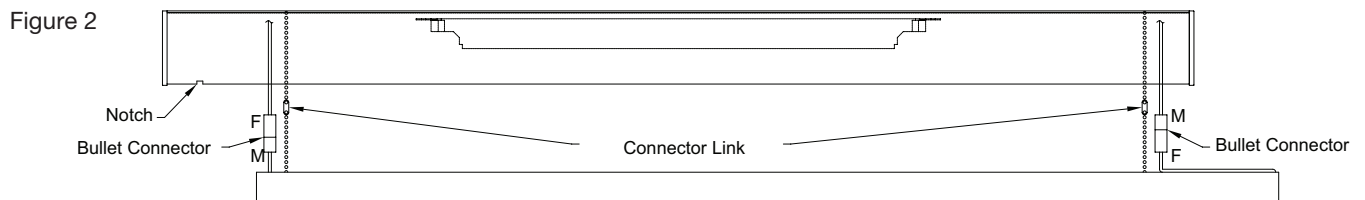
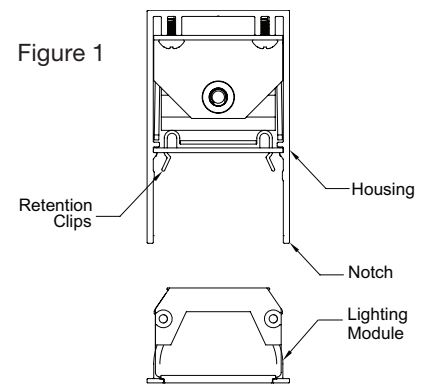

KIT COMPONENTS:

- Spring Arm Bracket (2 per fixture segment)
- Hanger Bracket (2 per fixture segment)

Installation Procedure

- Identify a fixture to be retrofit
- **TURN OFF POWER TO THE FIXTURE:** *Serious injury may occur if work is performed inside the fixture with power on*
- Pull the lighting module down from the housing, by gripping an exposed edge or if necessary by inserting a screwdriver into the slot at one end of the housing and twisting until the module unsnaps from its internal Retention Clips. (Fig 1)
- The Lighting Module can hang from its Safety Chains. (Fig 2)
- Unplug the bullet connectors at each end of the Lighting Module. (Fig 2)
- Disconnect the Safety Chains by unsnapping them at the Connector Link in the middle of the chain (Fig 2) *Note: If more than one Lighting Module is to be removed at one time; make note of which module belongs to which housing. Lighting Modules must be reinstalled in the original position in the original housing. Lighting Modules installed in the wrong position may not fit correctly or may be damaged by different driver settings.*
- Remove the Safety Chains from the Housing by unscrewing their mounting brackets. Also remove the safety chains from the top of the Lighting Module by removing the nut and discard. The exposed PEM stud is to be left in place. Do not disassemble the lighting module itself. (Fig 3)
- Remove all the Retention Clip Brackets from the fixture housing. Grip the bracket at one end near the housing and bend the bracket into the housing. Repeat at the other end of the bracket disengaging it from the channels. Remove and discard. (Fig 4)

Figure 3

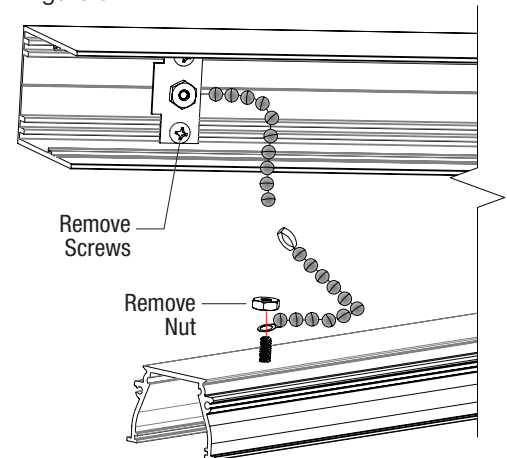
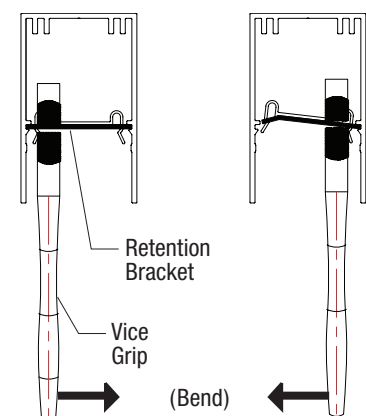

Figure 4



1" VersaLux Retrofit Mounting Kit

For use with VLN1 and SDN1

Installation Instructions

- The Spring Arm Brackets should be installed about 12" from each end of the Housing. Locate the nearest position that is clear of the driver. (Fig 5)
- Place the Spring Arm bracket in position inside the Housing, tucking any wires in the space between the Bracket and the Housing and not in the screw boss, then screw the Bracket into the screw bosses with the captive mounting screws. *Be careful not to pinch any wires running above the bracket or in the screw boss.* (Fig 5)
- Place another Spring Arm Bracket in a similar position at the other end of the Housing making sure the spring loaded arm is pointing in the same direction. Screw it in place in the same way as the first Bracket. (Fig 5)
- Reach inside the Housing and pull down the spring loaded arm. When fully extended down, the arm will stay in place. *Be careful when working with the arm as it will retract with force and may pinch fingers.* (Fig 5)
- Insert a flat blade screwdriver in the slot at the end of the spring loaded arm and turn it to open the gate allowing the Hanger Bracket Pivot to be inserted. (Fig 5)
- Identify the Lighting Module that belongs in the Housing. Position it so the bullet connectors are beneath their mate. *Note: The bullet connectors are opposite genders so the Lighting Module can only be installed one way.*
- Place one Hanger Bracket on top of the Lighting Module so the gripping edges are in the channel at the top of the Lighting Module. The hanger bracket should be positioned below the Spring Arm Bracket and the Pivot should be on the same side as the Swing Arm. (Fig 6)
- Tighten the clamp screw fully. *Note: With the clamp screwed tightly, ensure that the hanger bracket is snug when sliding along the top of the lighting module and does not come off.* (Fig 6)
- Repeat this process at the other end of the Lighting Module with another Hanger Bracket.
- Raise the Lighting Module and hook the Pivot on the Hanging Bracket into the opening at the end of the spring arm. Repeat at the other end of the module. (Fig 7)
- With a flat blade screwdriver close the gates on both swing arms preventing the pivot from disconnecting from the arm. *Note: it is essential the gate be properly closed as this is the safety device.* (Fig 7)
- Plug the bullet connectors into their mating connectors on both ends and tuck excess wire into the housing so it will not interfere with the Lighting Module when retracted.
- Swing the lighting module forward so the spring arms begin to close and slowly allow the lighting module to retract into the housing. It should fully or close to fully retract, based on the distortion in the Housing. If it does not, make sure wires or other components are not interfering.
- When closed, carefully slide the Lighting Module along the housing so it is properly positioned, either against the end cap or against its adjacent lighting module.

Figure 5

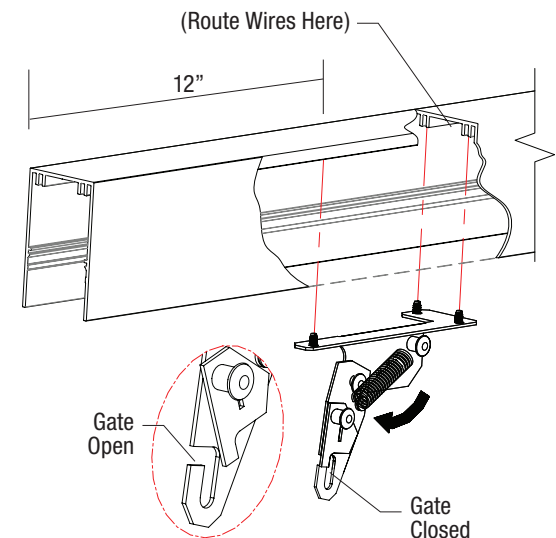

Figure 6

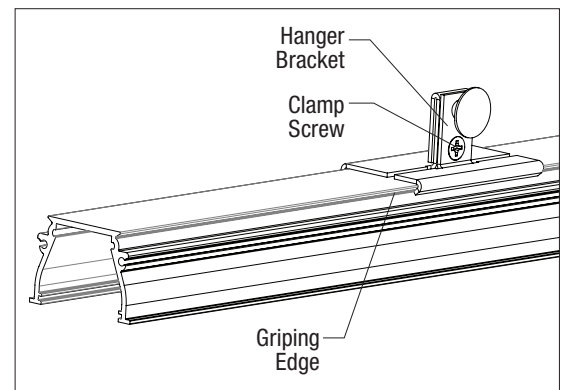

Figure 7

